

BIKE GP ALTERNATOR

Permanent Magnet



Permanent magnet alternators can tolerate high ambient temperatures and vibration allowing them to be directly mounted to racing engines. A separate regulator is required. This can be mounted in a location where the temperatures and vibration levels are lower.

Electrical

- Output 3 phase alternating current
- Cut-in speed 1,700rpm
- Frequency 750Hz on each phase at 15,000rpm

Performance with a DC3 regulator (14V into a resistive load with 1500mm cable at 25°C)

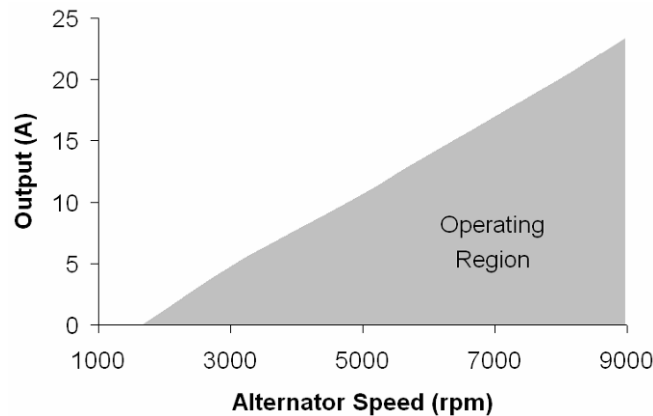

Note: Running outside of the operating region should be avoided.

Current (A)	0	5	10	15	20	22
Speed (rpm)	1700	3100	4800	6400	8000	8600

Cable and Connection Definition

- 55 spec 24AWG cable
- Cable length is shown order details but any length is available on request
- Connection (4 wires per phase)

Red wires	Phase 1
Green wires	Phase 2
White wires	Phase 3

Phases are interchangeable

Mechanical

- Weight 460g (excluding cable)
- Aluminium alloy body, hard anodised and dyed black
- Maximum speed 18,000rpm
- Bi-directional rotation
- Polyester cable boss for strain relief to body

Environmental

- Splash resistant to standard motorsport fluids
- Maximum humidity 100%
- Maximum temperature:

Stator	220°C (250°C short term)
Bearings	170°C
Rotor	150°C

BIKE GP ALTERNATOR

Permanent Magnet

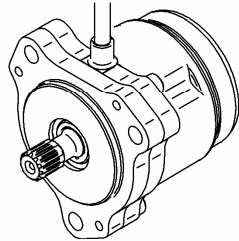

ISOMETRIC VIEW

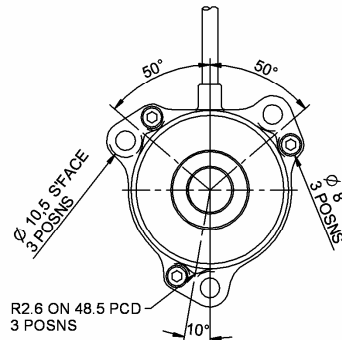

EXTERNAL SPLINE DETAIL (TO ANSI B92.1 1970)

NUMBER OF TEETH	12
MODULE	32/64
PRESSURE ANGLE	30°
PRIMARY DIAMETER	9.525
MINOR DIAMETER	8.268 - 8.471
MAJOR DIAMETER	9.810 - 9.900
BASE DIAMETER	8.2489

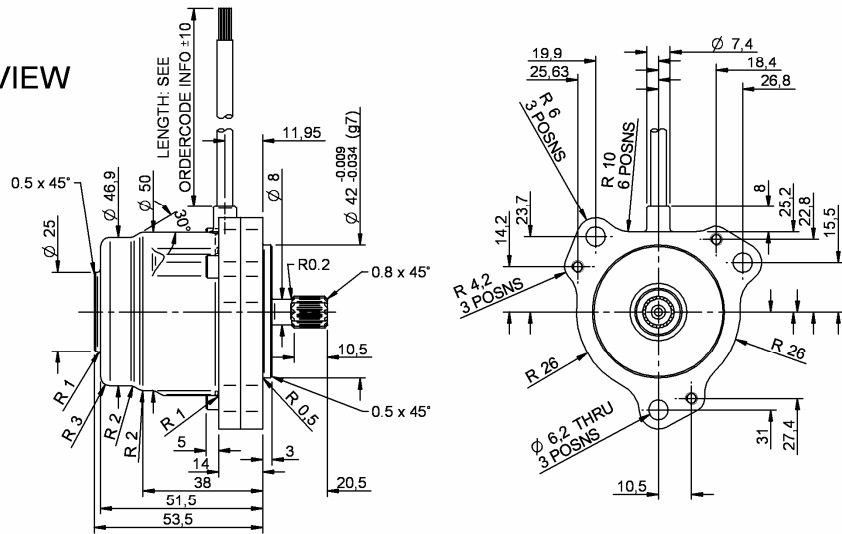

Ordercode O 030 650 017 022	Cable Length 1000mm
---------------------------------------	-------------------------------